

Quotation list

expandable container house

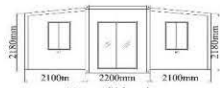

Front Side view

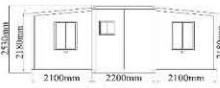

Back Side view



Left Side view



Right Side view

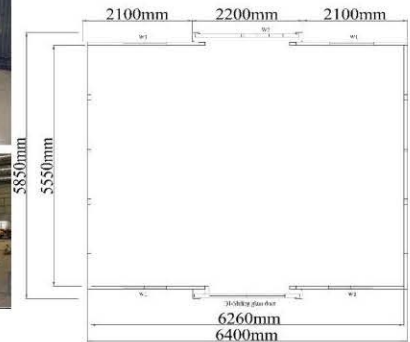

Measure	6400*5480*2520mm
Packing size	2200*5910*2520mm
Wall panel	50/75mm EPS/Rock wool/PU sandwich panel with double-sided 0.4mm PPGI
Steel structure	2.5~3.0mm galvanized steel structure
Windows	Plastic steel/Aluminum alloy double-layer hollow glass window with screens
Entry door	Plastic steel/Aluminum alloy double-layer hollow glass door
Internal door	Sandwich panel door,aluminum alloy frame, lock
Subfloor	18mm multi-plywood/cement-fibre board
Bathroom floor	PVC floor/ceramic tile
Bathroom	Shower,Seated Toilet,Wash Basin,Towel Rack+Mirror+Paper box
Kitchen	Sink with Cupboard(PVC Panel),stainless steel double sink,tap
Water pipe	PPR and PVC water supply and drainage pipe with fittings
Electric system	Switch,socket,lamp light,waterproof socket,distribution box.
Accessories	Paint,glass cement,floor nail,blind rivets etc.

A

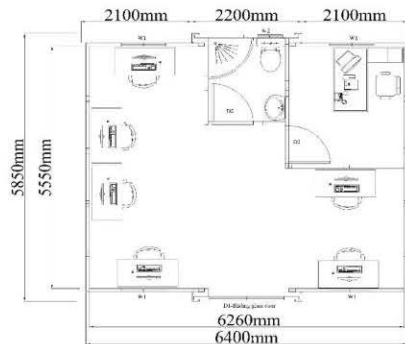



1 officeroom Layout

- 1) including roof, floor, wall panels;
- 2) with 1 glass slidig door (W1500*H2000mm), 4 sliding windows (800*1100mm) and 1 bathroom small window (600*600mm);
- 3) with electricity, DB box, switch, sockets, A/C sockets, wires, etc.;
- 4) with 1 bathroom (1 toilet, 1 shower, 1 washbasin, water pipes);

US\$8,500.00

<p>B</p>		<p>4 Bedroom Layout</p> <ol style="list-style-type: none"> 1) including roof, floor, wall panels; 2) with 1 glass slidig door (W1500*H2000mm), 4 sliding windows (800*1100mm) and 1 bathroom small window (600*600mm); 3) with electricity, DB box, switch, sockets, A/C sockets, wires, etc.; 4) with 1 bathroom (1 toilet, 1 shower, 1 washbasin, water pipes); 	<p>US\$8,500.00</p>
<p>C</p>		<p>3 Bedroom Layout</p> <ol style="list-style-type: none"> 1) including roof, floor, wall panels; 2) with 1 glass slidig door (W1500*H2000mm), 4 sliding windows (800*1100mm) and 1 bathroom small window (600*600mm); 3) with electricity, DB box, switch, sockets, A/C sockets, wires, etc.; 4) with 1 bathroom (1 toilet, 1 shower, 1 washbasin, water pipes); 5) 3 bedroom 	<p>US\$8,300.00</p>
<p>D</p>		<p>2 Bedroom Layout</p> <ol style="list-style-type: none"> 1) including roof, floor, wall panels; 2) with 1 glass slidig door (W1500*H2000mm), 4 sliding windows (800*1100mm) and 1 bathroom small window (600*600mm); 3) with electricity, DB box, switch, sockets, A/C sockets, wires, etc.; 4) with 1 bathroom (1 toilet, 1 shower, 1 washbasin, water pipes); 	<p>US\$8,800.00</p>
<p>E</p>		<p>Open Space Layout</p> <ol style="list-style-type: none"> 1) including roof, floor, wall panels; 2) with 1 glass slidig door (W1500*H2000mm), 4 sliding windows (800*1100mm); 3) with electricity, DB box, switch, sockets, A/C sockets, wires, etc. 	<p>US\$8,000.00</p>

F		<p>Open Space with a Toilet Layout</p> <p>1) including roof, floor, wall panels; 2) with 1 glass sliding door (W1500+H2000mm), 1 toilet door (700+2000mm), 4 sliding windows (800+1100mm) and 1 bathroom small window (600+600mm); 3) with electricity, DB box, switch, sockets, A/C sockets, wires, etc.; 4) with 1 bathroom (1 toilet, 1 shower, 1 washbasin, water pipes).</p>	US\$8,200.00
G		<p>1 Bedroom Layout</p> <p>1) including roof, floor, wall panels; 2) with 1 glass sliding door (W1500+H2000mm), 4 sliding windows (800+1100mm) and 1 bathroom small window (600+600mm); 3) with electricity, DB box, switch, sockets, A/C sockets, wires, etc.; 4) with 1 bathroom (1 toilet, 1 shower, 1 washbasin, water pipes); 5) with 1 small kitchen (1.8-2.0 m floor kitchen cabinet +1 sink + water pipes).</p>	US\$8,400.00
H		<p>2 Bedroom Layout</p> <p>1) including roof, floor, wall panels; 2) with 1 glass sliding door (W1500+H2000mm), 3 inner door(750+2000mm), 4 sliding windows (800+1100mm), 1 bathroom small window (600+600mm); 3) with electricity, DB box, switch, sockets, A/C sockets, wires, etc.; 4) with 1 bathroom (1 toilet, 1 shower, 1 washbasin, water pipes); 5) with 1 small kitchen (1.8-2.0 m floor kitchen cabinet +1 sink</p>	US\$9,000.00

Customisation welcome. Volume discounts available.

Item sanitary fitting and kitchen is on option item. Please advise if you do not need it.

Valid time: 10 days from issued.

Delivery time: 35 days after get deposit.

The 3D plan is for refer. The offer is according the drawing which both party confirmed.

Expandable Container House

1 bedroom & 2 bedroom house

Ready: toilet room, kitchen cabinet, plumbing system and electrical system

Load: 2 unit/40HQ

Package size: L5850*W2200*H2530mm

Expandable size: L5850*W6400*H2530mm



Installation:
4 workers in
1 hour



Flat Pack Packing



Roof Installation



Floor Installation



Wall Installation



Expandable House Finished