

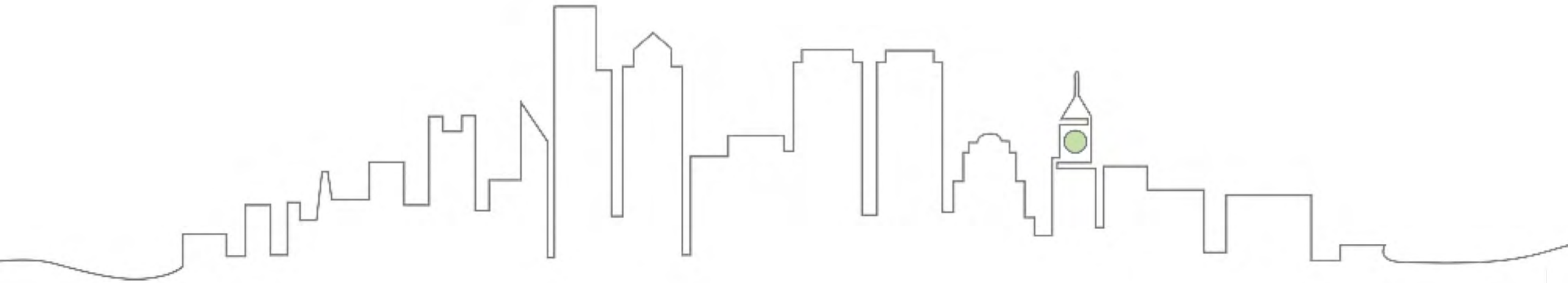

Proposal of 24 rooms hotel



Project brief

Project name	
Location	
Type of building	Two storey hotel
Total building area	730 square meters
Storey	2
Qty. of bed rooms	24
Bedroom	$3.5 \times 3.45\text{m} = 12.1\text{m}^2$
Bathroom	$2.34 \times 1.68\text{m} = 4\text{m}^2$
Climate	Hot/Cold
Wind speed	60m/s
Land required	$48 \times 26\text{m}$

24 rooms hotel



Ground floor plan

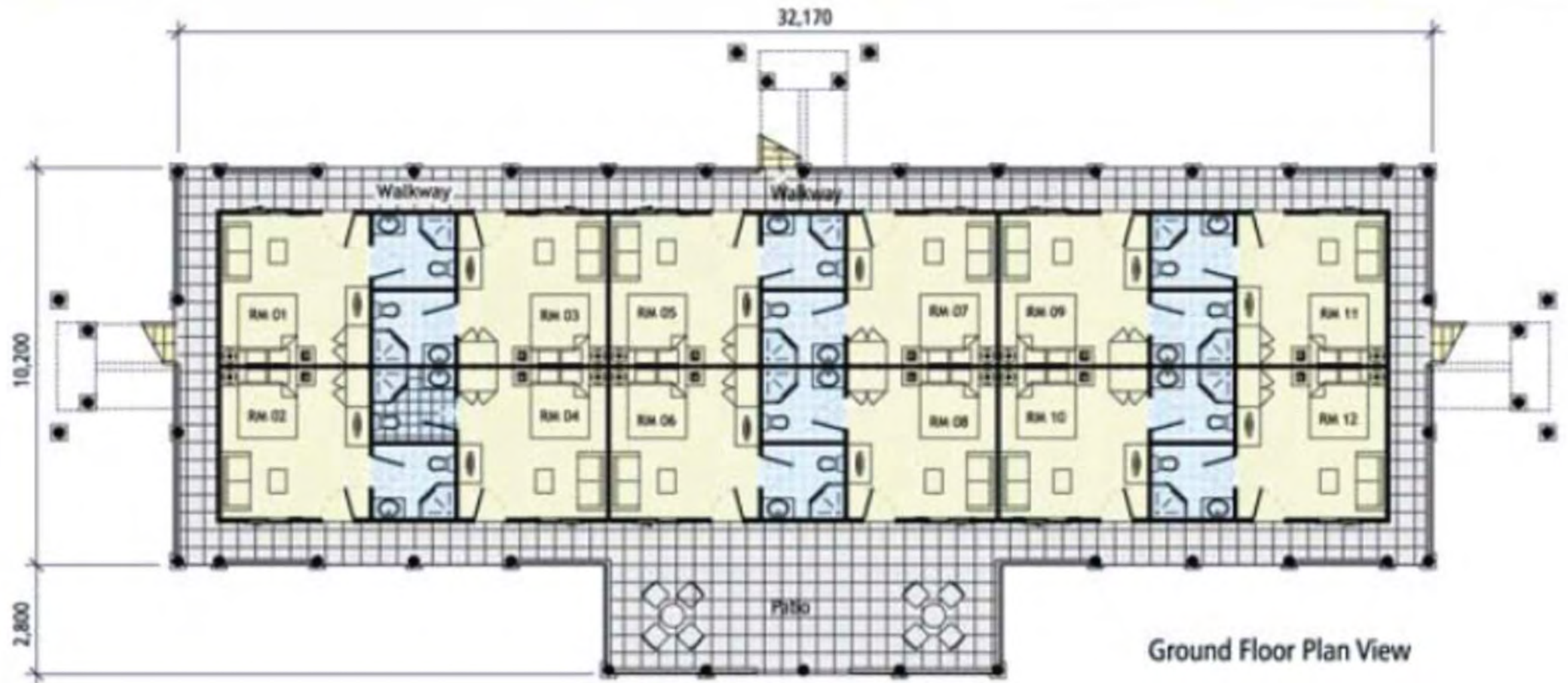

First floor plan

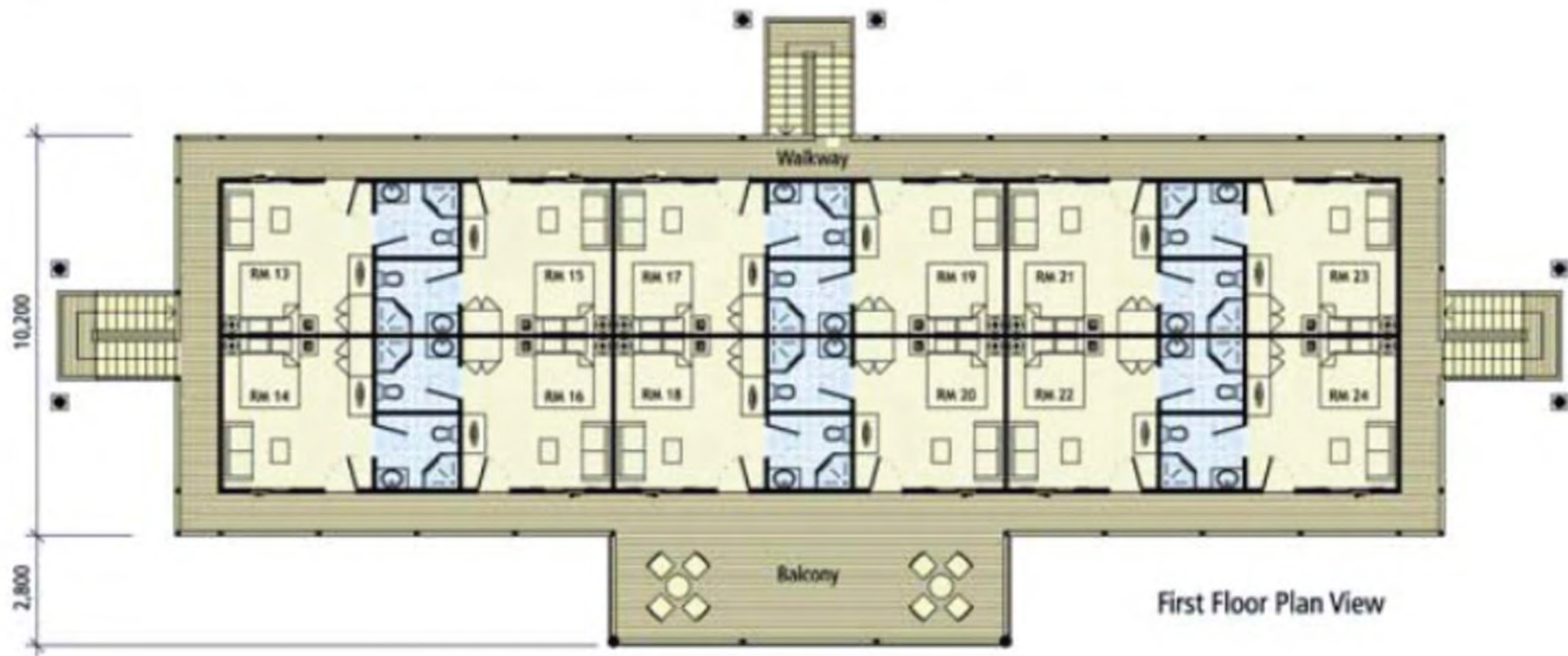

Materials display

Light steel frame



The structural frame is made of AS1397 G550 AZ150 0.75/0.95mm light steel, which has both aluminum-unique corrosion-resistance and heat resistance and zinc-unique "galvanic behavior".

Light steel frame

Lipped Cee Section Properties

Name		S8975	
Grade		G550	
Coating		AZ150	
Yield Stress	f_y	Mpa	550
Tensile Strength	f_u	Mpa	550
Height	h	mm	89.0
Width Top	w_t	mm	41.0
Width Bottom	w_b	mm	39.0
Thickness	t	mm	0.75
Lip Top	l	mm	10.1
Feed		mm	182.0
Area		mm ²	136.5
Mass		kg	1.072
Second Moment of Area I_x		mm ⁴	174103
Second Moment of Area I_y		mm ⁴	29996
Radius of Gyration r_x		mm	35.7
Radius of Gyration r_y		mm	14.8
Centroid Postion x		mm	12.6
Centroid Position y		mm	44.0
Shear Centre x_o		mm	33.2
Shear Centre y_o		mm	0
Polar Radius of Gyration r_{o1}		mm	43.6
Tortion Constant J		mm ⁴	25.6
Warping Constant I_w		mm ⁶	48912422
Sectional Modulus Z_{xt}		mm ³	3957
Sectional Modulus Z_{xb}		mm ³	3869
Sectional Modulus Z_{yt}		mm ³	2381
Sectional Modulus Z_{yb}		mm ³	1056

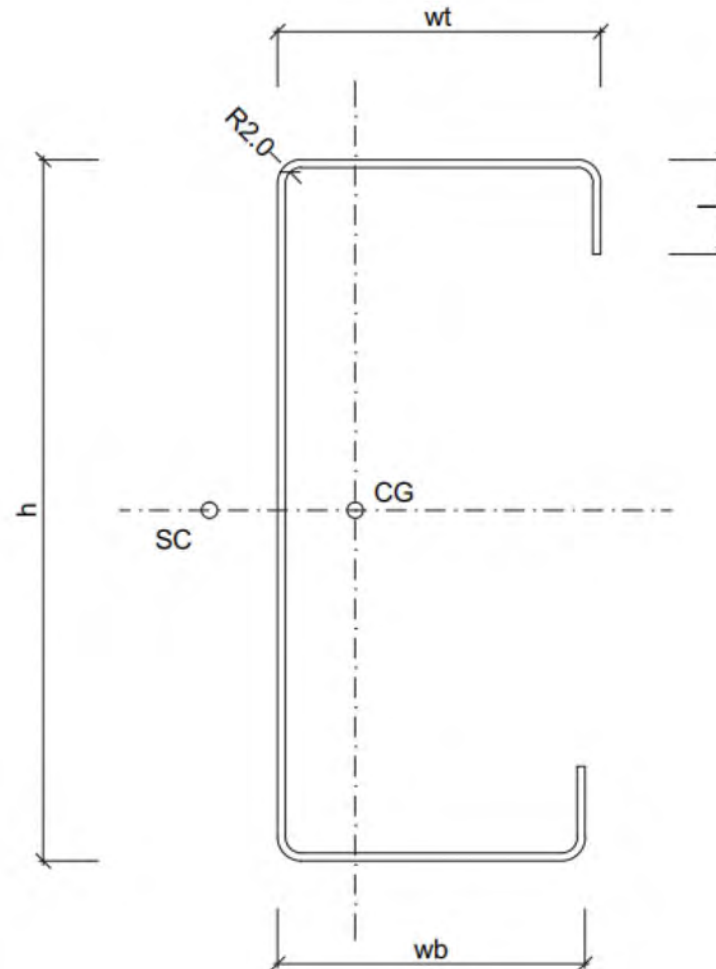

Light steel frame-wall frame

Light steel wall panel: AS1397/ASTM A792 AZ150 G550 89mm*41mm*0.75/0.95mm cold formed steel, pre-assembled.



Light steel frame-roof truss

Light steel roof truss: AS1397/ASTM A792 AZ150 G550 89mm*41mm*0.75/0.95mm cold formed steel, pre-assembled.



Light steel frame-floor joist

Light steel floor joist: AS1397/ASTM A792 AZ150 G550 89mm*41mm*0.75/0.95mm cold formed steel, pre-assembled.



Steel frame-outdoor stair

Steel escape stair



Roofing-Roof batten



35mm steel batten for roof

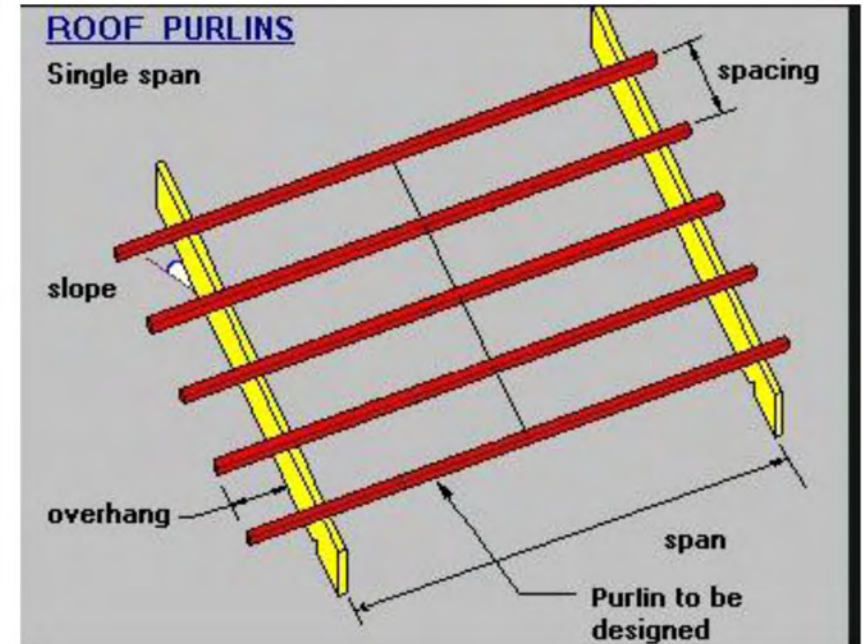
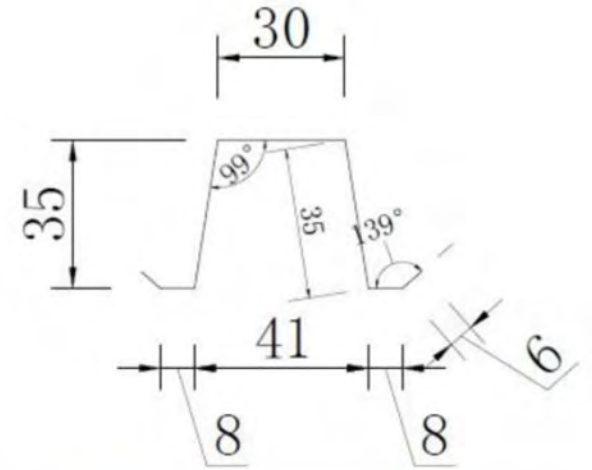

Roofing-Vapor barrier

Vapor barrier for roof

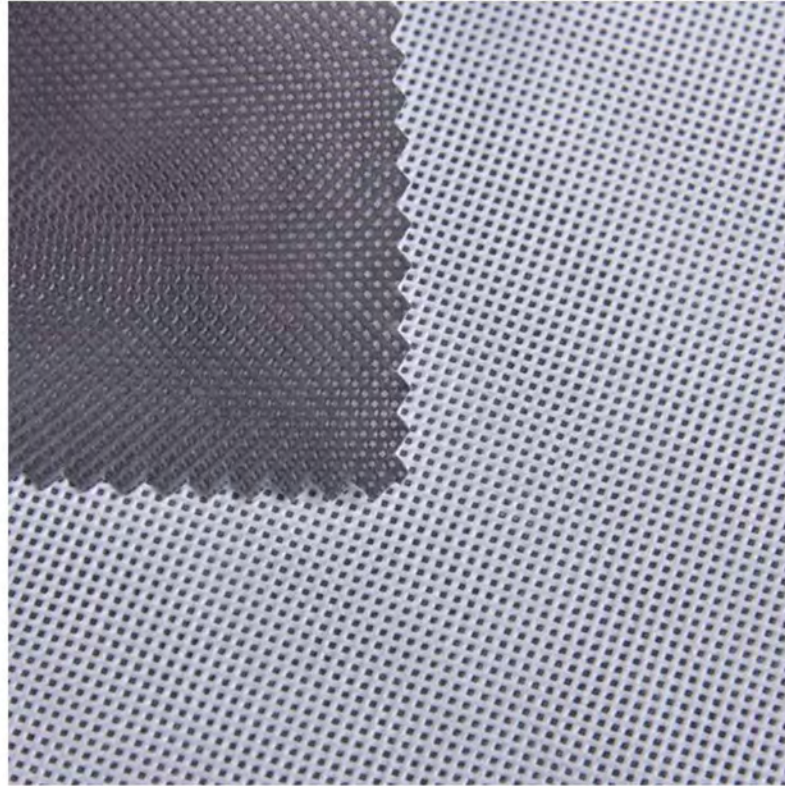

Roofing-Reinforcing layer-OSB board

15mm OSB board as reinforcing layer for roof



Roofing-roof tile-Colorbond steel sheet

Colorbond steel sheet/trimdek, with various colors

Raw material: Galvanized steel (Zinc 30g), Painting: outside 15um, inside 5um

Corrugated



Color 1: Zinalume



Trimdek

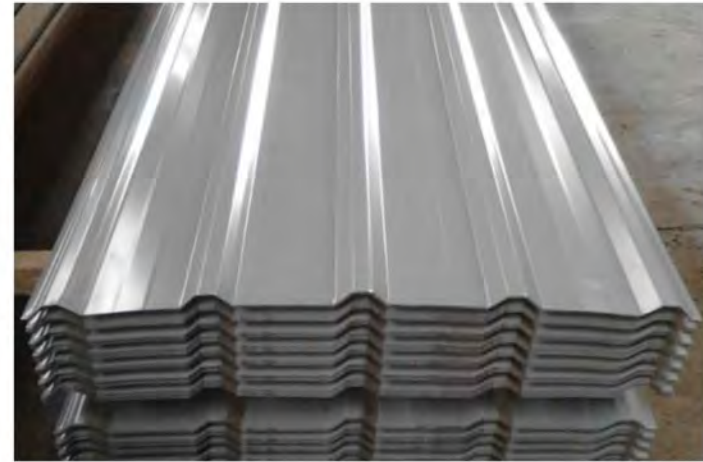

Color 2: White grey



Color 3: Deep grey

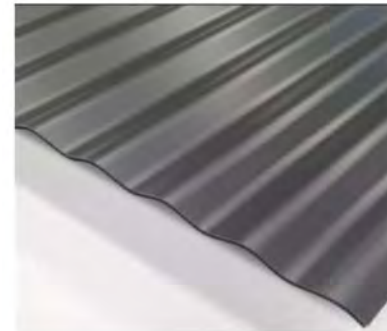

Roofing-Facial board/flash

Steel facial board/flash same color of roof tile

Fascia board

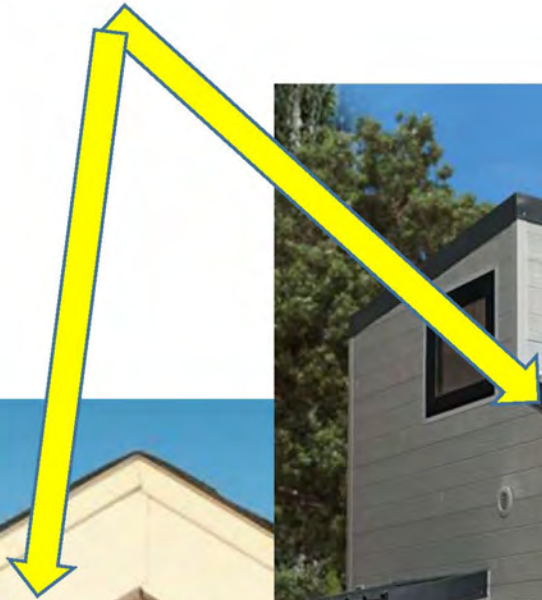

Flash



Roofing-Soffit

6mm fiber cement board medium density as soffit

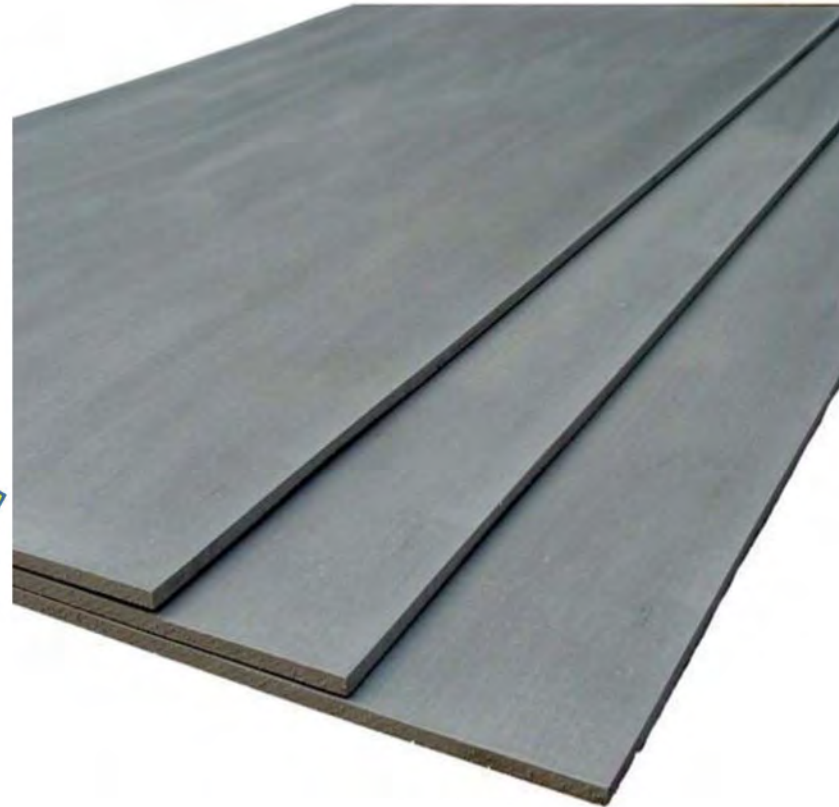

Roofing-PVC gutter & down pipe

PVC gutter and downpipe



Exterior wall-Cladding-WPC wall panel

WPC composite wooden panel, Termite resistant, high strength



Exterior wall-Vapor barrier

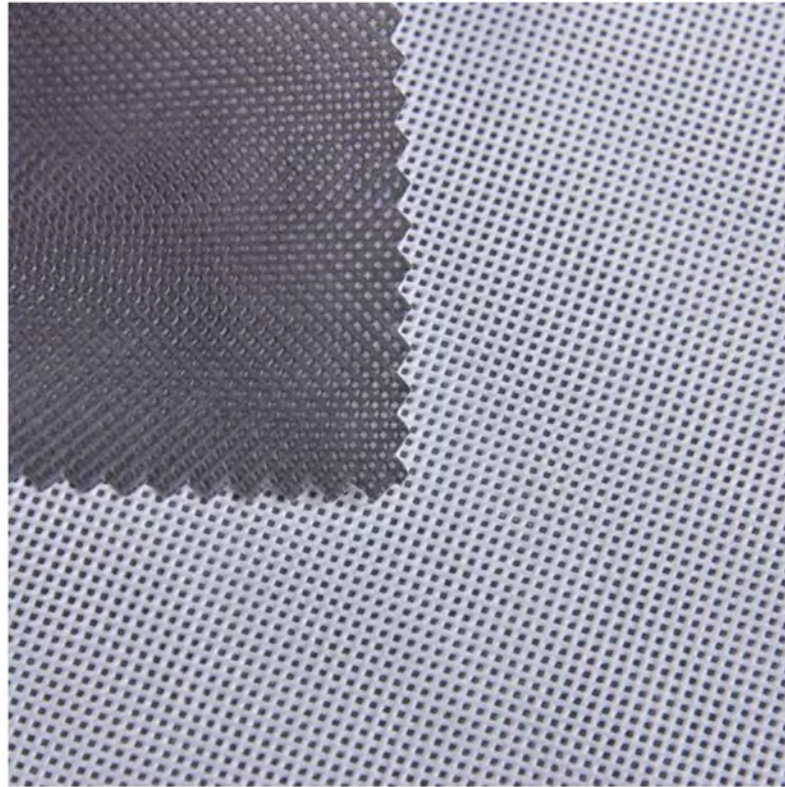

Exterior wall-Basic insulation

Insulation in light steel wall panel: Glass wool 10mm R2.5



Ceiling-Ceiling batten

22mm steel ceiling batten

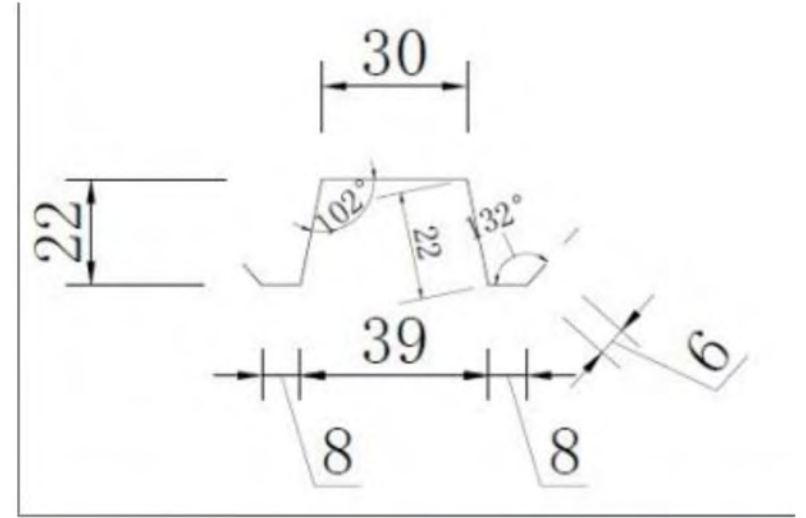

Ceiling-Ceiling panel

Ceiling:

Gypsum board, water proof gypsum board for wet area ceiling.

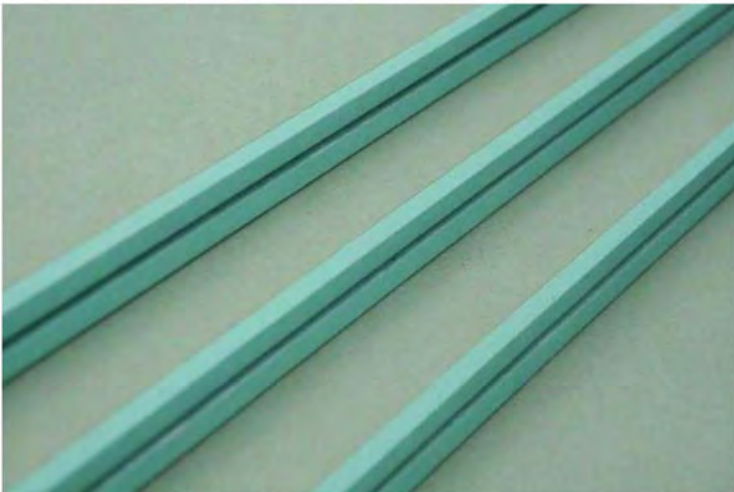

6mm fiber cement board for wet area ceiling, Soffit



Ceiling-corner line-gypsum corner line

50/90mm gypsum corner line

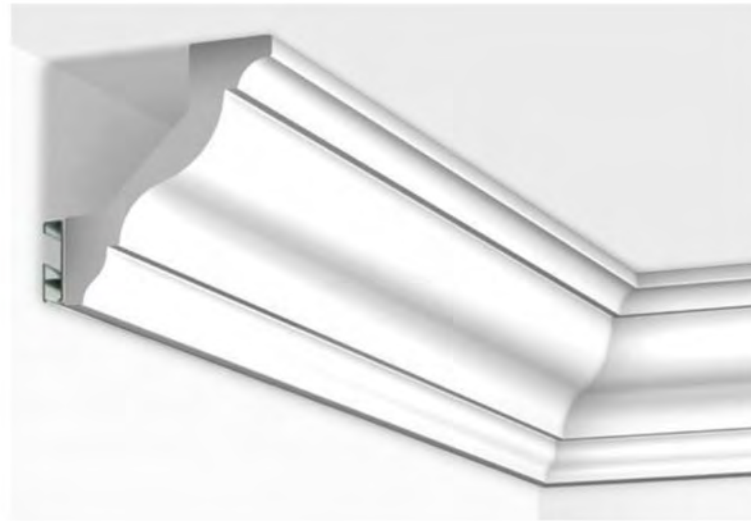
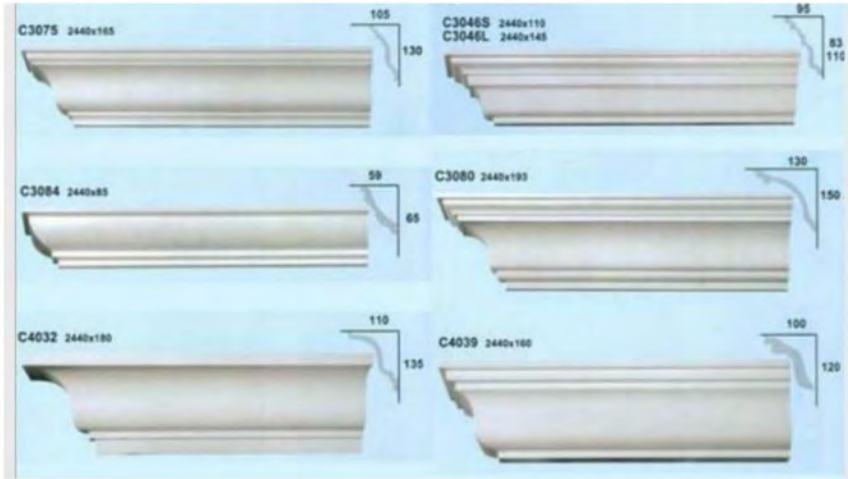

Interior wall-interior wall panel

Gypsum board for interior wall dry area 9/12mm



9mm Fiber cement board for lining of interior wall wet area



Interior wall-finishing-Ceramic tile

Ceramic tile for wet area wall finishing



Floor-floor board-CFC panel

18mm fiber cement panel as floor board



Flooring-Laminated flooring

Laminated flooring (MDF)-dry area 9/12mm



2706



2707



K01



K05



TV23

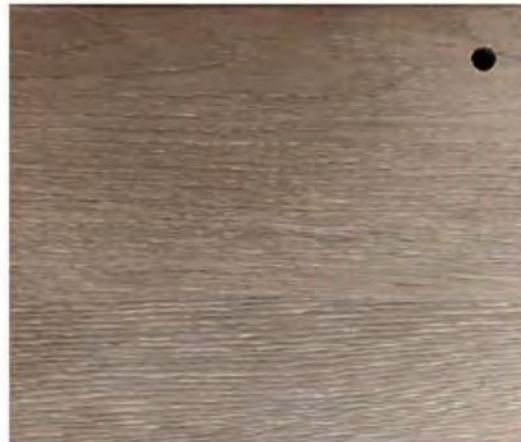

TV25



TV28



TV29

Flooring-Ceramic flooring

Ceramic tile flooring-wet area

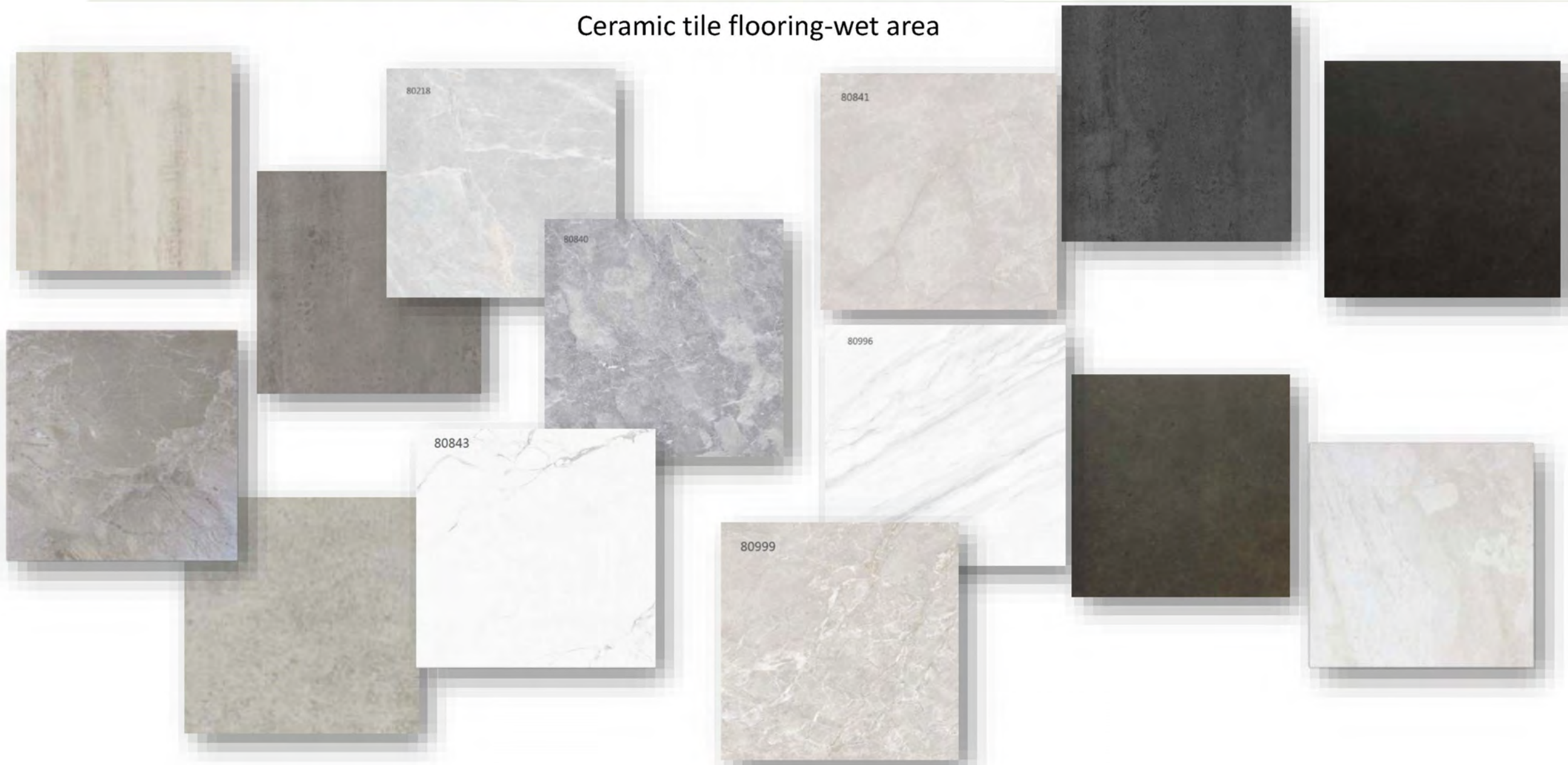

Flooring-Skirting

Skirting:

PVC 100mm High PVC Skirting



Exterior door-Steel security door

Normal steel security door-option of styles



WJ-5011



WJ-7001



WJ-7005



WJ-7008



WJ-7005(子母)



WJ-7008(子母)



WJ-5006



WJ-5007



WJ-5010



WJ-5011

Exterior door-Steel security door

Normal steel security door-option of colors (Transfer printing)



Interior door-MDF door

Melamine veneer MDF door-option of styles



Interior door-MDF door

Melamine veneer MDF door-options of styles



Interior door-MDF door

Melamine veneer MDF door-Color of finishing



Golden wood



Black ashtree



Light Oak

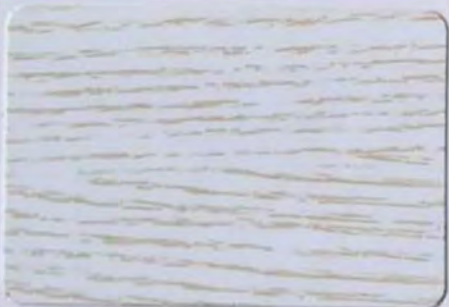

Golden wood-2



Apple wood

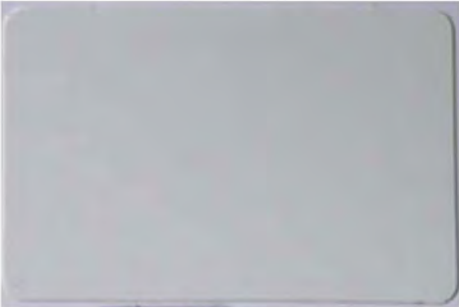

Ivory



Sky blue



Thailand teak



Red maple



Red parquet



Yellow Oak



Bintangor



Black walnut



Wenge



Red walnut

Interior door-MDF door

Melamine veneer MDF door-Color of finishing



Pure white



Teak



White oak



Maple



Red rosewood



Red cherry



Walnut



Red Oak

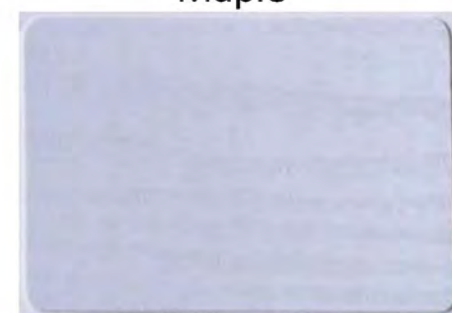

White ash tree



Princess red



Light grey



Suzhou tricolor



Iron walnut



Transverse



Cathaya

Please note that the colors are only for Melamine finishing, the material of door is MDF.

Interior door-handles

Handle for interior door



Fitting-Railing for stair/balcony/terrace

Painted steel railing



Glass doors and windows

Aluminum/PVC frame single/double/triple temperature glass windows/exterior doors, AUS/NZ/CE/US std.



Electric wiring

Electric wiring

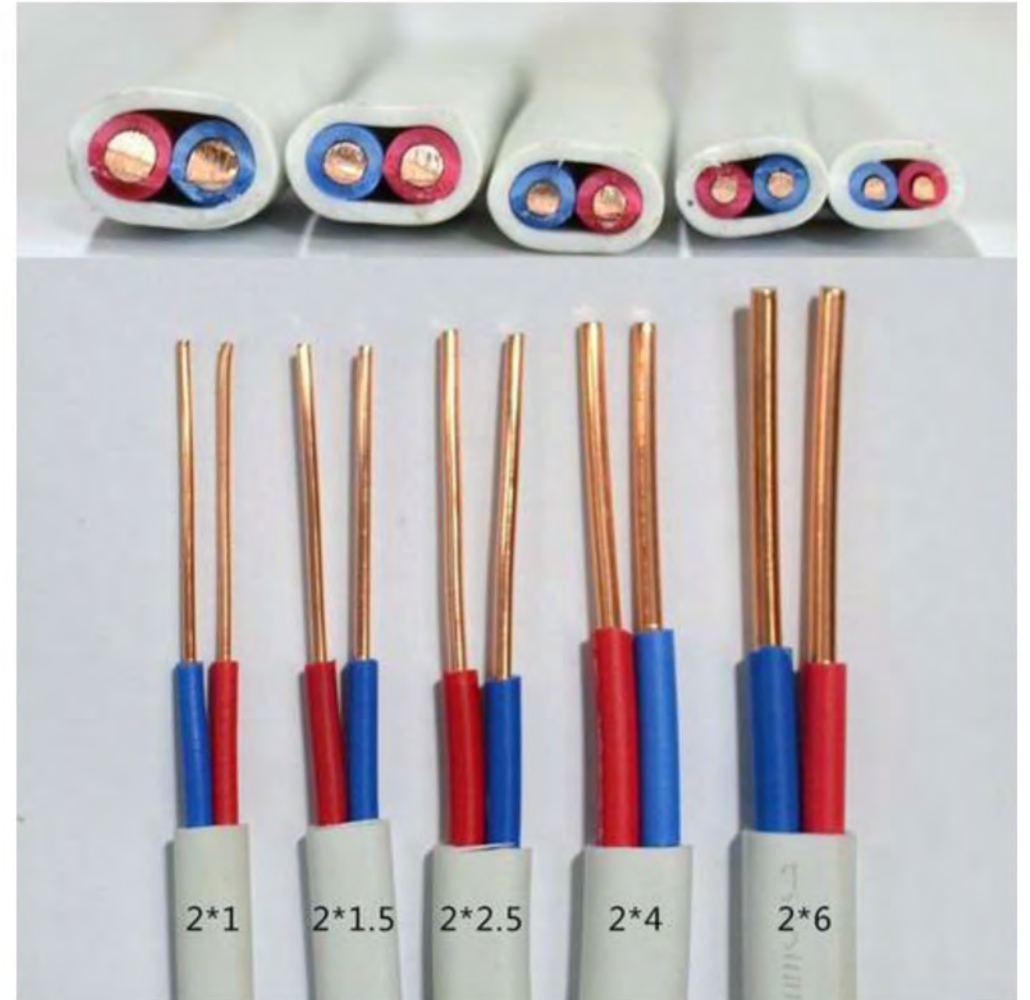

Plumbing

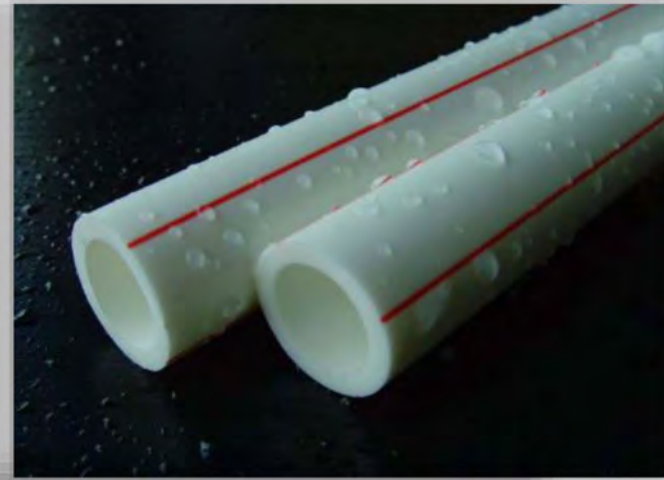

Water supply pipes and sewage pipes



Bathroom-Freestanding Vanity set

Free standing Vanity & wash basin



2010



6004



6006



Bathroom-Shower cabin/shower glass



171010g



171011g



D1040



SL8-390



SL8-620



D1060



GD1440



gd1740



9004

800×800×2150

900×900×2150

1000×1000×2150

Bathroom-Vanity & shower faucet

Faucet for vanity and shower



9010505



9010360



9010598



9130091



KE-7056



KE-2000-1/2



KE-2004-1



KE-2004-2



Bathroom-Toilet

Normal toilet



KZ8001



KZ8822



KZ8031



KZ8063



KZ8106



KZ8022



KZ8082



KZ8122

Toilet (water mark)



KZ558



KZ559



KZ563

Order procedure

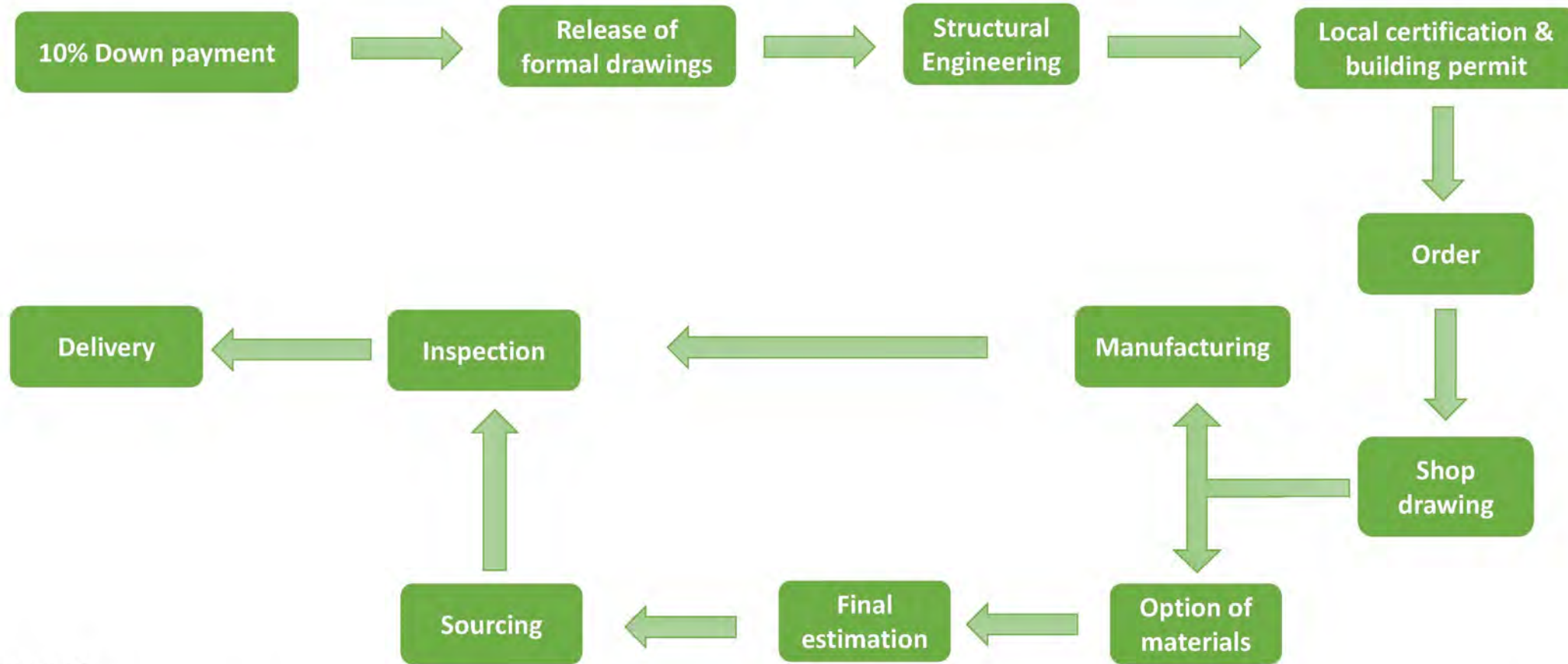

Payment:

10% amount for light steel frame structural engineering according to the customer's local building code, estimation list of materials and release of other drawings.

40% amount to start the manufacturing after the project is approved by the local council.

50% amount before delivery.

A close-up photograph of two people shaking hands in a business setting. The person on the left is wearing a dark suit jacket, a white shirt, and a watch. The person on the right is also wearing a dark suit jacket. In the background, there is a laptop on a desk and a person's hands holding a pen. The scene is brightly lit, suggesting an office environment.

trueblue

Thank you!