

01

The Overall Solution

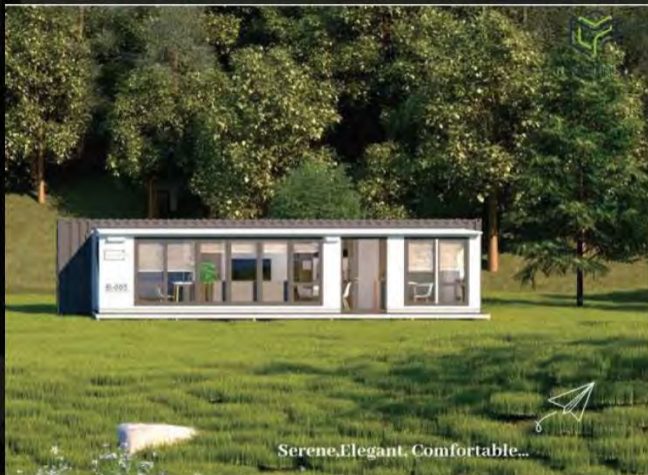

- Specially designed for **overseas markets**
- Drawer-style extension function
- Maintains quality of container housing
- Addresses **transportation** and tariff issues
- Provides the **space** of two containers for the cost of one
- Adapted from container modifications for a rational structure
- Long lifespan and easy **modular** assembly.

01

The Overall Solution



3D Renderings: Exterior Look

01

The Overall Solution.



Floor Plan 1

01

The Overall Solution



3D Renderings: Interior Look

01

The Overall Solution



3D Renderings: Interior Look

01

The Overall Solution.

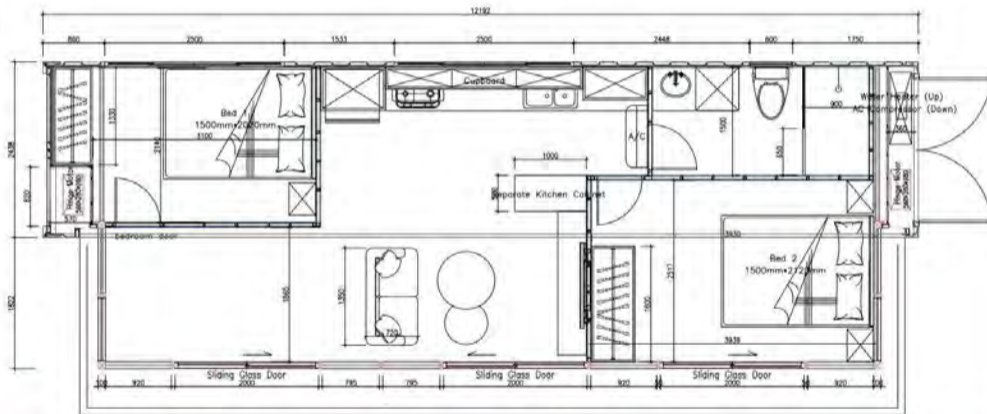

Floor Plan 2

01

The Overall Solution



3D Renderings: Interior Look

01

The Overall Solution



3D Renderings: Interior Look



01

The Overall Solution

Size Reference
for the 40HQ
Model:

- Standard 40HQ shipping container when contracted, suitable for direct shipping to save on freight and duties.
- Interior area can be expanded to 1.75 times when the expandable module is fully extended.

Before extension: 29.72m^2



STANDARD SIZE

After extension: 51.76m^2



01

The Overall Solution

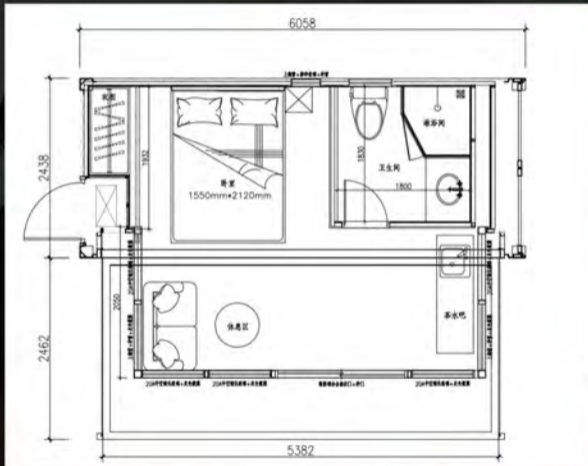

Floor Plan

01

The Overall Solution

Size Reference
for the 20HQ
Model:

- Standard 20HQ shipping container when contracted, suitable for direct shipping to save on freight and duties.
- Interior area can be expanded to 1.75 times when the expandable module is fully extended.

Before extension: **14.77 m²**

After extension: **25.72 m²**



STANDARD SIZE



01

The Overall Solution

Turnkey service

- Customized exterior and interior layouts
- Comprehensive support for plumbing, electricity, and furnished decoration
- Extendable section for easy use with plug-and-play functionality



1. Whole product hoisting and transportation



2. Product unloading



3. Product expanding

Professional service
Convenient and fast

02

Craftsmanship Details

Exterior Wall Production Process



Sturdy shipping container appearance and structure



Reinforced structure with galvanized square pipes



Manual insulation filling on all sides, up to 100mm thick



OSB for enhanced interior wall hanging capability



02

Craftsmanship Details Insulation Material Options



Rockwool

Thermal conductivity $\leq 0.043 \text{ W/m}\cdot\text{K}$

Fire rating: A1

Environmentally friendly flame-retardant material, commonly used in the European and Australasian markets.



Glass Wool

Thermal conductivity $\leq 0.034 \text{ W/m}\cdot\text{K}$

Fire rating: A1

Environmentally friendly flame-retardant material, commonly used in the European and Australasian markets.



PU Foam

Thermal conductivity: $\leq 0.024 \text{ W/m}\cdot\text{K}$

Fire rating: B1

Excellent thermal insulation, often used in North America and extremely cold regions.



FRP-XPS Panel

Thermal conductivity: $\leq 0.028 \text{ W/m}\cdot\text{K}$

Fire rating: B1

Newly developed material by the company, lightweight, seamless, and provides excellent thermal insulation, commonly used in RVs and refrigerated vehicle exteriors.

02

Craftsmanship Details

Kitchen and bathroom interior wall



Various tiles can be seamlessly laid to enhance the interior decor style

02

Craftsmanship Details Glass and Doors/Windows

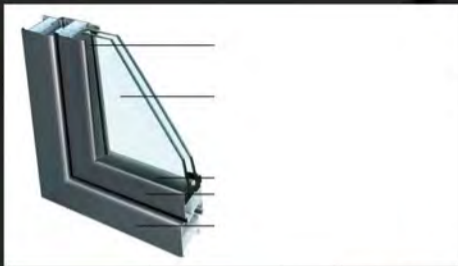

Default configuration: thermally broken aluminum doors and windows, double-layer insulated glass for heat insulation and noise reduction.

- **Upgrade option: double-layer LOW-E glass with low-emissivity silver film for soundproofing, insulation, heat resistance, UV protection, and privacy.**

02

Craftsmanship Details

Flooring



Option 1: Waterproof film-covered base layer board + XPS buffer layer + SPC flooring (default configuration), upgradeable to multi-layer solid wood flooring



Option 2: waterproof film-covered base layer board + Vinyl flooring (default configuration)

02

Craftsmanship Details

Expandable Structure: Hinge System



Note: 40ft model requires two hinge motors, placed on the left and right sides of the container.



Electric hinges: raise and lower the front wall of the container, which serves as the platform for the expandable section.
(Upgradeable to a manual + electric integrated hinge system)



Electric hinge motor: located in the equipment room on the side of the container.

02

Craftsmanship Details

Expandable Structure: Sliding Rails and Expansion Module



Stainless steel sliding rails
+ water-stop frame



Expansion module: increases interior space by 0.75 times



03

Product and Logistics Solution

Shipping Container High Cube (SOC) Transport:
Direct loading onto the ship for transportation

20HG		
	6.058m	5.7m
	2.438m	2.2m
	2.896m	2.5m

40HG		
	12.192m	11.8m
	2.438m	2.2m
	2.896m	2.5m



Product and Logistics Solution

Selection of shipping containers as the main structure for housing

PRO

1. Sturdy structure and materials contribute to increased durability.
2. Offers the maximum interior space compared to self-built containers.
3. When the expandable section is retracted, it retains the standard shipping container shape, allowing for direct shipping and minimizing transportation costs.
4. SOC (Shipper Owned Container) eliminates the need to return containers to the shipping company upon arrival at the port, resulting in lower port-related costs.

CON

1. Higher cost compared to self-built containers.
2. SOC shipping containers have restrictions on excessive modifications to their external appearance (e.g., extensive glass or decorative cladding), as it may hinder direct transportation and may not be accepted by some shipping companies, leading to fewer available shipping routes.
3. Limited size options, typically available in 20-foot and 40-foot dimensions.
4. Due to the structural constraints of shipping containers, the height and area of the expandable section are slightly smaller than those of self-built containers of the same size.

03

Product and Logistics Solution

40HQ

SOC

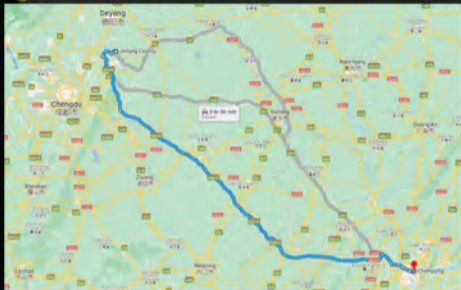

Export Through	Chongqing Port
Distance from Factory	around 300km (nearest port)
FOB Local Charge	USD 1200.00 / 40HQ
Note	Chongqing port primarily handles 40HQ and 20GP shipping container cargo.

03

Product and Logistics Solution

20HQ SOC



Export Through

Shanghai or Chongqing
(Risk of rejection at the Chongqing port)

Distance from Factory

2000km(Shanghai)
300km (Chongqing)

FOB Local Charge

Shanghai: USD 2300 / 2*20HQ
Chongqing: USD 1500/ 2*20HQ

Note

Shipping companies only dispatch 20HQ cargo in pairs from the port. This means that you need to have at least two sets of 20HQ cargo to choose this mode of transportation.



How to customize special products?

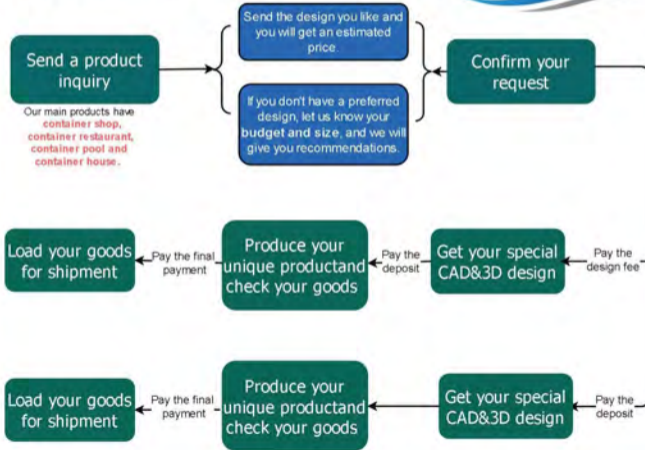

1. Pay a design fee of US\$1000 have drawings created, finalize details, and lock in the price. If the project moves to the production stage, a 50% advance payment is required, and the design fee can be deducted from the total.

2. Upon project completion (including installation of all appliances and equipment), we will confirm every detail with the customer through video. Fragile furniture will be disassembled, repackaged, and secured.

The remaining 50% payment will be collected before the goods leave the factory.

04

Design Fee Charging Standards

Design Charge		One individual Container Project
Design Cost	CAD Drawings	USD1000.00 / Case
	3D Renderings	
Delivery Time	CAD Drawings	The first draft of CAD design drawings will be delivered within 7 working days after payment.
	3D Renderings	After the drawings are confirmed, 3D renderings will be delivered within 2 working days.

Note 1: After paying the advance payment, the design fee can be deducted from the product payment. If placing an order directly, there is no need to pay the design fee.

04

Price Details

Basic Configuration		Specification	QTY
Main Structure	Shipping Container	20HQ: L8.06*W2.44*H2.89m 40HQ: L12.19*W2.44*H2.89m	1 unit
	Wall & Roof	From inside to outside: 10mm integrated wall panel/wood veneer panel + 12mm roof OSB baseboard + 50 to 100mm insulation layer+ galvanized steel frame + Shipping container shell	1 pack
	Base & Flooring	From bottom to top: Shipping container base+Waterproof membrane baseboard + (XPS extruded board)+SPC stone plastic floor/floor adhesive	1 pack
	Hinge System	Motor Power: 4.0 kW; Lifting Height: 1-100 meters; Lifting Speed: 7-14 meters/minute	40HQ: 2 sets; 20HQ: 1 set;
	Fold-out System	304 stainless steel sliding track system; 50mm FRP-XPS flip board; Expandable module (customizable width); Three sides of the expandable module can be customized as full glass.	1 pack
	Door & Windows	Thermal break aluminum, 5+9+5 hollow glass doors and windows Non-expandable part includes 1 window not exceeding 1.2m1m in size Expandable part includes 1 double sliding glass door not exceeding 2m*2m and 2 windows not exceeding 1.2m*1m in size	1 pack
	Electric & Drainage System	Local standard wires, ceiling or recessed spotlights (4 square meters each), industrial plugs, pipeline systems, distribution boxes, sockets, and switches.	1 pack
EXW Price	20HQ Expandable Unit	USD 19900.00	
	40HQ Expandable Unit	USD 32350.00	

04

Price Details

Optional Pack		Specification	Budget (Estimation)
See detailed prices in the quotation sheet	Partition Wall	20HQ: 23m ² 40HQ: 50m ²	20HQ: USD1265.00 40HQ: USD 2750.00
	Apperance Upgrade	2mil thermal insulation one-way glass film + 304 diamond aluminum alloy screens and screen doors + Venetian blinds	20HQ: USD 700.00 40HQ: USD 1450.00
	Bathroom Pack	Floor-to-ceiling ceramic tile + Standard siphonic toilet + Glass shower partition+ Exhaust fan + Bathroom vanity set + Shower set + Towel rack set	1 Bathroom: USD 2000.00
	Kitchen Pack	Quartz countertop cabinets + cupboards + SUS304 sink + Four-eye Stove + Range hood	20HQ: USD 1200.00 40HQ: USD 2550.00
	Appliance	Water heater + 1.5P split air conditioner (non-branded) + Smoke detector	USD 575.00
	Furnitures	Custom multi-layer solid wood wardrobe + Double bed + Bedside table + Compact double-seat sofa + Coffee table + Vanity/Desk set	-
	Second Floor Decking Pack	WPC flooring + Galvanized steel guardrail + Outdoor wrought iron stairs + Outdoor table and chair set	-
FOB Local Charge	20HQ : FOB Chongqing	USD 1500.00 / 2*20HQ	
	40HQ: FOB Chongqing	USD 1200.00 / 40HQ	

Price Summary Sheet

Acquisition Cost 40HQ Shipping Expandable Container				
SN	Item	QTY	Unit	Price (USD)
1	Basic Configuration	1	unit	
2	Partition Wall	1	pack	
3	Apperance Upgrade	1	pack	
4	Bathroom Pack	1	pack	
5	Kitchen Pack	1	pack	
6	Appliance & Furnitures	1	pack	
7	FOB Chongqing Charge	1	batch	
8	Shipping Cost: Chongqing Port - Savannah Port	1	40HQ	
9	Import Tax & Duties (27.9%)+Customs Clearance Fee	1	batch	
Total Budget				\$47,975.00

Acquisition Cost 20HQ Shipping Expandable Container				
SN	Item	QTY	Unit	Price (USD)
1	Basic Configuration	2	unit	
2	Partition Wall	2	pack	
3	Apperance Upgrade	2	pack	
4	Bathroom Pack	2	pack	
5	Kitchen Pack	2	pack	
6	Appliance & Furnitures	1	pack	
7	FOB Chongqing Charge	1	batch	
8	Shipping Cost: Chongqing Port - Savannah Port	2	20HQ	
9	Import Tax & Duties (27.9%)+Customs Clearance Fee	1	batch	
Total Budget (2 units)				\$58,380.00